



CONQUER THE WORLD

**SERVICE MANUAL BODY –
RENEGADE MOTORCYCLE
300 CC**



RENEGADE COMMANDO



RENEGADE SPORTS



VEHICLE MAJOR DIMENSIONS

REN2

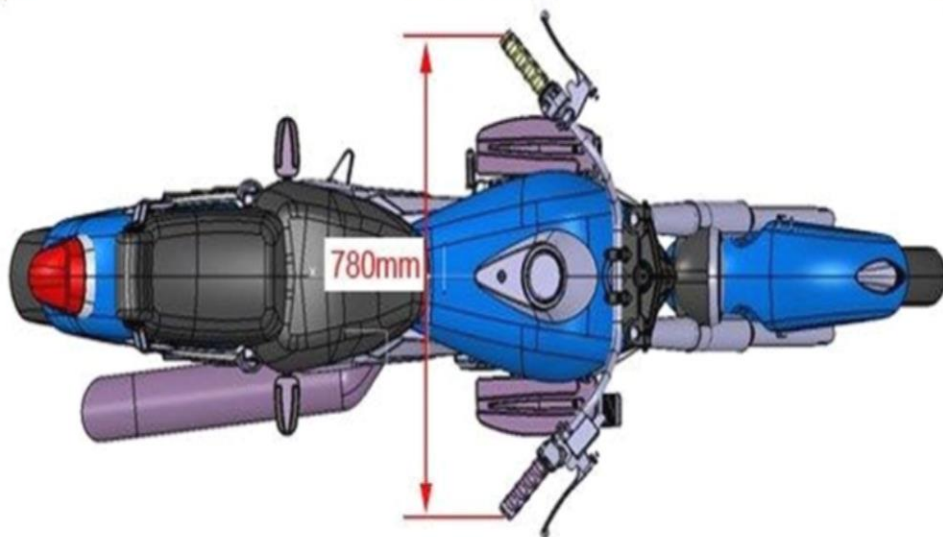
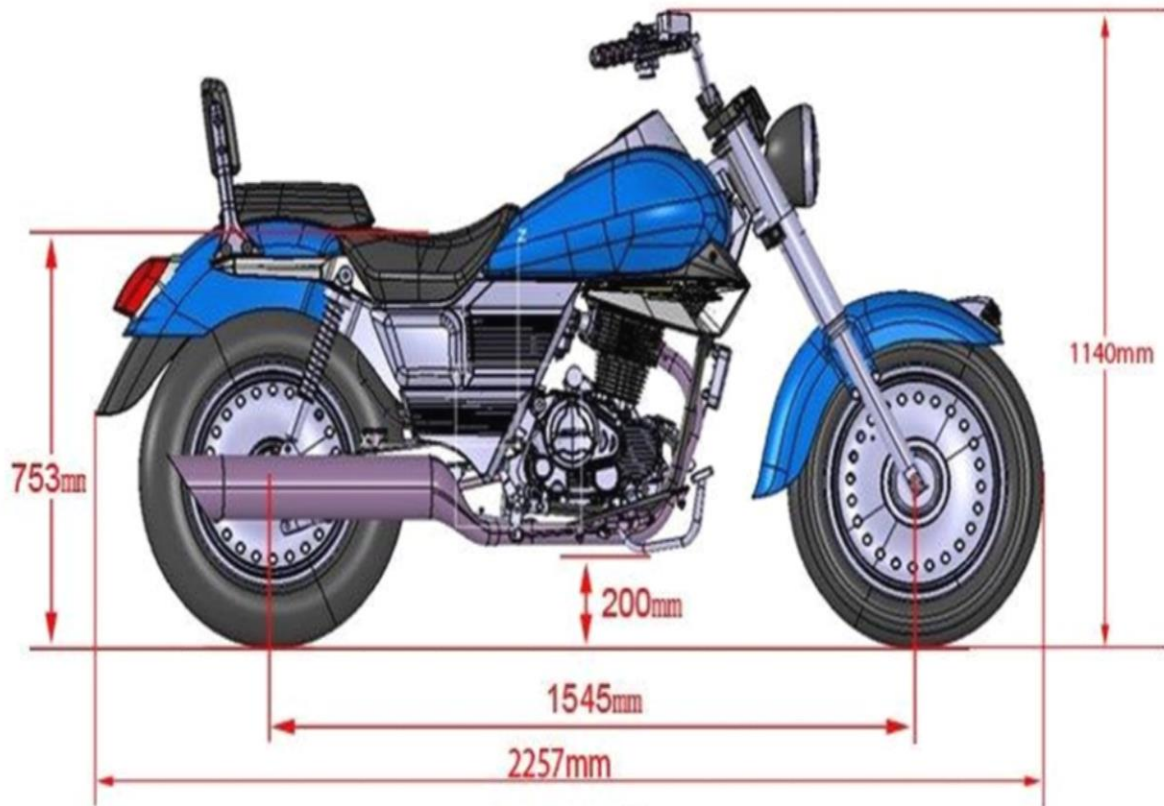

VEHICLE IDENTIFICATION NUMBER (VIN)

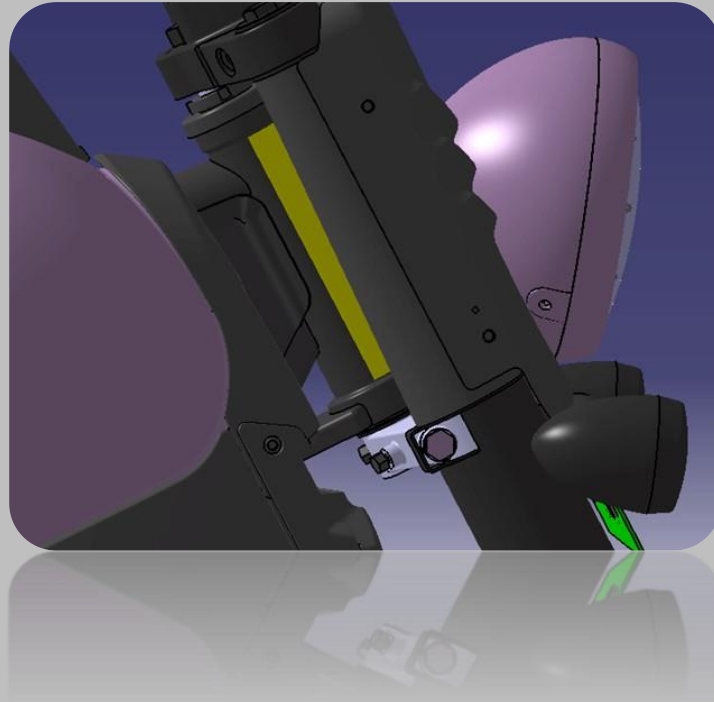

**VIN number is punched on the Right Side of the Frame,
Generally on the Head Tube as shown in the Picture (Yellow
marked area).**

LOCATION OF IMPORTANT BODY PARTS

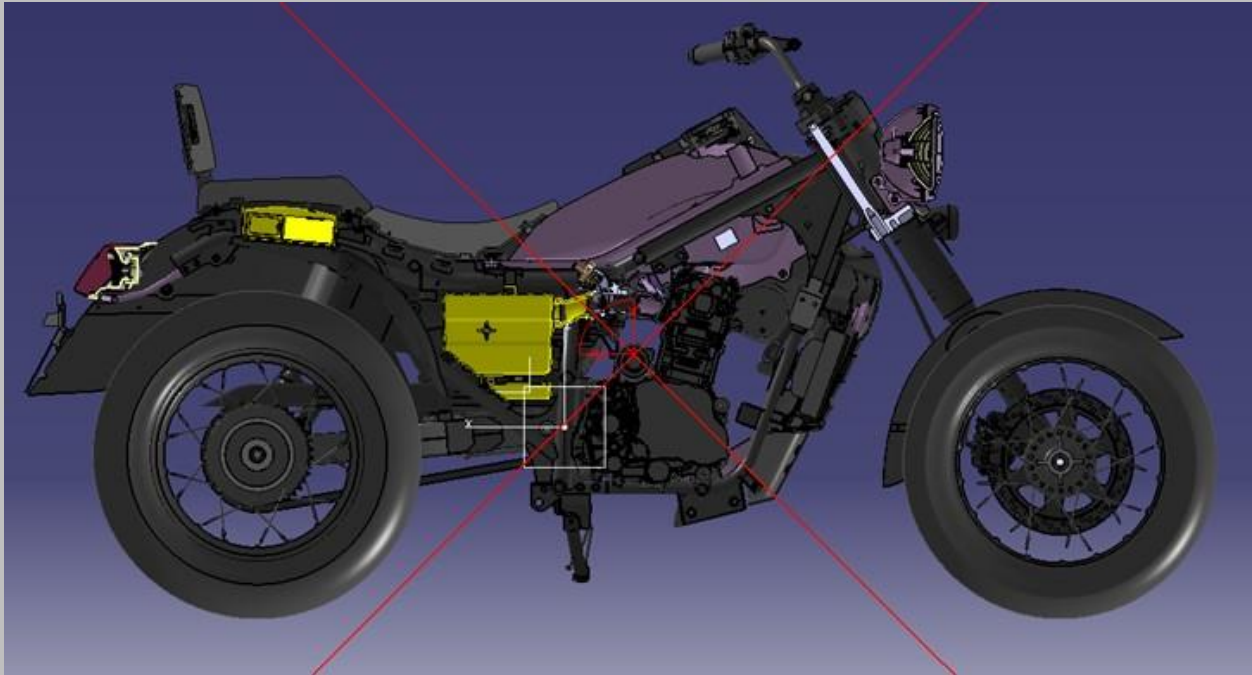

1. Storage box
2. Air cleaner
3. Tool box
4. Cushioned backrest
5. Rear fender assembly
6. Rear Wheel
7. Rear Brake panel
8. RH side cover
9. Fuel Tank
10. Chassis

LOCATION OF IMPORTANT BODY PARTS



1. Radiator
2. Carburetor/Throttle body
3. Battery
4. Rear sprocket & Chain drive
5. Pillion hand hold
6. Main stand
7. Side stand
8. Front wheel & Front fender
9. Front Hydraulic brake assembly
10. Handle bar assembly
11. Front fork assembly

VEHICLE SPECIFICATIONS

GROUP	DESCRIPTION	<i>RENEGADE COMMANDO</i>	<i>RENEGADE SPORTS S</i>
SUSPENSION	FRAME	TUBULAR	TUBULAR
	SUSPENSION – FRONT	HYDRAULIC TELESCOPIC D 41 MM	HYDRAULIC TELESCOPIC D 41 MM
	SUSPENSION – REAR	TWIN HYDRAULIC WITH SPRING	TWIN HYDRAULIC WITH SPRING

VEHICLE DIMENSIONS	KERB WEIGHT	172 Kg (with 90% fuel* oil)	172 Kg (with 90% fuel* oil)
	WHEELBASE	1545 MM	1545 MM
	WIDTH	780 MM	780 MM
	LENGTH	2257 MM	2227 MM
	HEIGHT	1140 MM	1140 MM
	MIN GROUND CLEARANCE	200 MM	200 MM
	SEAT HEIGHT	750 MM	750 MM
	FUEL TANK CAPACITY	18 LIT	18 LIT
	RESERVE	2 Lit (Approx)	2 Lit (Approx)

VEHICLE SPECIFICATIONS

GROUP	DESCRIPTION	<i>RENEGADE COMMANDO</i>	<i>RENEGADE SPORTS S</i>
WHEEL RIM & TYRE	WHEEL RIM SIZE – FRONT	2.50 x 16	2.75 – 17
	WHEEL RIM SIZE – REAR	3.50 x 15	3.5 – 15
	TYRE SIZE – FRONT	110 / 90 - 16 (TVS)	110 / 70 - 17 (TVS) (Tubeless)
	TYRE SIZE – REAR	140 / 90 - 15 (TVS)	140 / 90 - 15 (TVS) (Tubeless)
	TYRE TYPE	TUBE	TUBELESS

BRAKES	BRAKES – FRONT	DISC D 280 MM, 2 Piston Caliper	DISC D 280 MM, 2 Piston Caliper
	BRAKES – REAR	Drum, 130 mm	Drum, 130 mm
	WHEELS	Steel Spokes	Alloy Wheel
	BRAKE OIL CAPACITY	60 ML	60 ML
	BRAKE OIL GRADE	DOT 3 / DOT 4	DOT 3 / DOT 4

DISMANTALLING & ASSEMBLING OF VEHICLE

1. Seat rear & front.
2. Side cover RH
3. Side cover LH
4. Engine decoration covers LH & RH side.
5. Fuel tank.
6. Air cleaner
7. Rear fender
8. Rear sprocket, brake panel & rear wheel
9. Rear swing arm
10. Front wheel
11. Front fender
12. Front fork
13. Steering stem
14. Rear brake pedal
15. Radiator
16. Side & main stand
17. Sub frame & engine mounting with chassis

1-REAR & FRONT SEAT ASSEMBLY



Remove rear seat

- **Flange bolt-M6*16
(T wrench-10mm)**



Remove front seat

- **flange bolts-M6*12*2 No's
(T wrench-10mm)**

2-RIGHT SIDE COVERS



RIGHT SIDE COVER

- Remove Lower side cover RH by unlocking with key.
- Remove rear side cover RH by pulling out side carefully.
- Remove 3 pan head screws, M6*16, to remove front side cover RH.

Reassembly in the reverse order of removal and disassembly.

3- LEFT SIDE COVERS



LEFT SIDE COVER

- Remove rear side cover LH by pulling out side carefully.
- Remove 3 screws to remove front side cover LH.
M6*16 No's-Pan head

Reassembly in the reverse order of removal and disassembly.

4-ENGINE DECORATION COVER LH & RH SIDE



Remove LH & RH side Engine decoration cover.

Allen screw M6*16*2 No's each side (Allen key 4mm)

Reassembly in the reverse order of removal and disassembly.

5-FUEL TANK

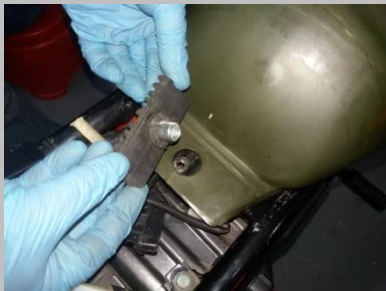

- Drain all the petrol from Fuel tank.
- Disconnect fuel tube from fuel knob.
- Remove Fuel tank rear side bolt.
M8*35 with plain washer-
(T Wrench 12mm)
- Remove rubber cushion.
- Disconnect fuel gauge & speedometer couplers.

**GASOLINE IS HIGHLY
FLAMMABLE AND EXPLOSIVE.
KEEP HEAT, SPARK & FLAME
AWAY**

Reassembly and installation
the fuel tank in the reverse
order of removal and
disassembly.

6-AIR CLEANER



- After removing Fuel tank as per procedure given(Refer-Point 5).
- AIR FILTER ASSY can be taken out.

Flange bolts M6*16*3 No's
(T wrench10mm)

Tightening torque-10~12 Nm

Remove tool kit box by pulling it outside.





AIR CLEANER ELEMENT CLEANING

- Remove Rh side cover assembly as per steps given in point number-2.
- Remove intake pipe by removing 3 screws 20 mm length.
- Remove air cleaner element for cleaning.

**CLEAN THE ELEMENT BY AIR.
REPLACE IF DAMAGED**

**Reassembly in the reverse
order of removal and
disassembly.**

7-REAR FENDER



**Remove rear seat.
Remove storage box
screws M5*17*3 No's.**

Remove backrest

- **Allen bolt M8*16mm*2
No's with spring washer
(2 each RH & LH side).**
- **Tool-Allen key 6mm**
- **Loosen RL & LH Rear Shock
absorber upper mounting
dome nut M10 (T-18).**
- **Remove both side rear
fender decoration plates.
Allen bolts-M8*30 (Allen
key-6 mm).**
- **Remove Tail lamp lower
nut M6 , 1 No.-Ring
spanner-8*9).**

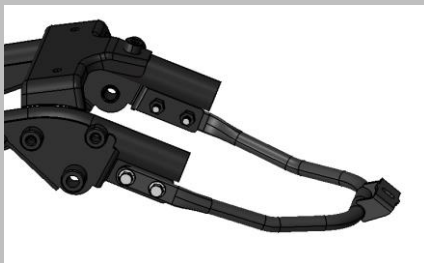

- Remove Rear fender carefully

ENSURE THAT REAR FENDER IS REMOVED WITHOUT ANY SCRATCHES ON IT.

DISCONNECT ALL THE WIRING FROM REAR FENDER BEFORE REMOVING.

Rear fender bracket is mounted on main frame with the help of M6*16*4 bolts.

Reassembly in the reverse order of removal and disassembly.

8-REAR SPROCKET, REAR BRAKE PANEL & REAR WHEEL

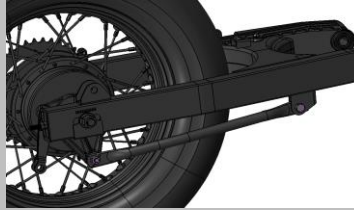

- Remove rear brake cam nut.

CHECK THAT BRAKE CAM IS WORKING SMOOTHLY, APPLY GREASE IF REQUIRED



- Remove Brake panel nut from position rod.



- Remove Rear axle nut M with the help of ring spanners.



Remove rear axle from the wheel.



Remove Left bush rear sprocket & Flange Rear wheel carefully from rear wheeling arm.



**Check damper rear wheel for any damage.
Replace if found damaged.**

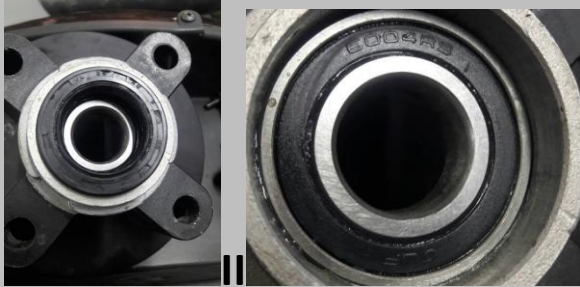

Check Dust seal & bearing (6004RS) for proper fitment & smooth rotation.
Replace if found worn out/noisy.



Remove right bush rear wheel & Panel rear brake carefully from rear wheel.



CLEAN HUB INNER SURFACE & BRAKE LINEAR SURFACE BEFORE REFITTING.

REPLACE BRAKE SHOES IF FOUND WORN OUT OR HARD.

REPLACE HUB IF INNER SURFACE FOUND WORN OUT.

SERVICE LIMIT
1-HUB id-131 mm.
2-Brake liner thickness-3 mm



**CHECK THAT BEARING-
(6302/2RS)REAR WHEEL Rh
SIDE IS FITTED PROPERLY IN
HUB.**

**Reassembly in the reverse
order of removal and
disassembly.**

9-REAR SWING ARM



- Remove Bolt & nut of swing arm.

**Bolt-M14*279*1.5 mm
Nut-M14 Lock nut.**

Tightening Torque- 60-70 Nm

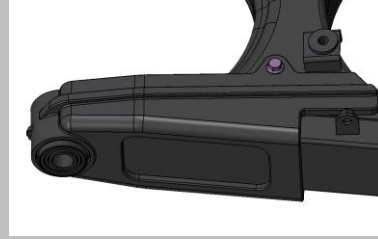

Chain slider bolt-Hexagonal flange-M6*16*2 No's(upper & lower side).

1. CHECK THAT BOTH SIDES DUST COVER & CHAIN SLIDER ARE FITTED PROPERLY & NOT IN DAMAGED CONDITION.
2. CHECK THAT BOTH SIDE ARMS BUSH ARE IN GOOD CONDITION.THERE SHOULD NOT BE ANY DAMAGE/WERING.
3. CHECK THAT GREASING IS DONE ON BOTH SIDES BUSHES & BEARINGS.



**Reassembly in the reverse
order of removal and
disassembly.**

10-FRONT WHEEL



- Remove Front nut from wheel RH side.

Nut-M14(Ring spanner-20/22).

- Remove axle bolt-M14*268.

Tightening Torque-60~70 Nm.



While refitting front wheel check that speedometer sensor is properly fitted in groove.

-



- Remove Bush-
28*15*22
(OD*ID*T).



**CHECK THAT DUST
SEAL & BEARING
BOTH THE SIDES
(6302 2RS)
ARE IN
GOOD CONDITION.**

**REPLACE IF
DAMAGED/WORN
OUT**





**If bearing is noisy,
worn out, should be
removed with the
help of special tool.**



**Inside there is one
spacer & rubber
washer to properly
locate spacer.**





Fitment of both sides bearing with the help of special tool.



Replace the disc if worn out & thickness is <4.2 mm.



To replace, remove 6 Allen screws.

Allen Bolt-M8*25



While tightening-

- **Apply Loctite 290 before tightening**
- **TORQUE- 25~28 Nm**

11-FRONT FENDER



- Remove bolts on each LH & RH side.

**Bolt-M6*16*2(2 RH & 2 LH side)
T Wrench-10 mm**

12-FRONT FORK



Front fork can be removed from vehicle with or without front wheel.

- Remove STEERING BOLT M14*30 CHROME.

**TORQUE WHILE TIGHTENING-
60~70 Nm**



- Remove Head light decoration cover side & top screws.

Side Allen screws-M6*12*4(both sides-Allen key 4 mm)



Top screws-M6*16*2(Allen key 4 mm).

- **Loosen UPPER TRIPLE CLAMP-M10*30*2 No's both sides.**

TIGHTENING TORQUE WHILE ASSEMBLING-30~35 Nm



- **Remove STEERING STEM ASSY**

HEX BOLT-M10*40*2 both sides.

TIGHTENING TORQUE WHILE ASSEMBLING-25~35 Nm.





- To remove Head light & decoration cover, remove lower nut-M8*1 No's.
- Remove Handle assembly carefully along with upper triple clamp without damaging any other part.
- Remove upper & lower rubber dust seals from shocker tube cover.
- Remove both side covers.
- Remove front brake caliper assembly.

Bolt-M8*45

While assembling-

- Tightening torque-20~22 Nm
- Apply Loctite-412 before fitting bolts.



- **Remove complete Fork assembly from Steering stem.**

Reassembly in the reverse order of removal and disassembly.

13-STEERING STEM



- Remove Stem steering nut carefully. Nut-M25.



Tightening torque while assembling-20~22 Nm



- Remove dust proof cover.
- Remove top upper cone.
- Remove bearing cage.



- Now remove complete Steering stem from Chassis Main pipe.



**TAKE CARE OF STEM
THREADING FOR ANY
DAMAGE.**



WHILE ASSEMBLING, APPLY SUFFICIENT QTY OF GREASE ON BEARING SURFACE

Reassembly in the reverse order of removal and disassembly.

Complete details of Steering

Stem & Suspension



ITEM	Description	Quantity
1	FRONT SUSPENSION-RIGHT $\Phi 41$ MATT BLACK	1
2	FRONT SUSPENSION-LEFT $\Phi 41$ MATT BLACK	1
3	OIL SEAL, FRONT FORK	2
4	UPPER RUBBER FRONT SUSPENSION $\phi 41 \times \phi 47 \times 17$	2
5	FRONT SUSPENSION UPPER DECORATION COVER-R, MATT BLACK	1
5	FRONT SUSPENSION UPPER DECORATION COVER-R BASE COLOR	1
6	FRONT SUSPENSION UPPER DECORATION COVER-L, MATT BLACK	1
6	FRONT SUSPENSION UPPER DECORATION COVER-L BASE COLOR	1
7	LOWER RUBBER FRONT SUSPENSION $\phi 41 \times \phi 65 \times 15$	2
8	FRONT SUSPENSION LOWER DECORATION COVER-R, MATT BLACK	1

8	FRONT SUSPENSION LOWER DECORATION COVER-R BASE COLOR	1
9	FRONT SUSPENSION LOWER DECORATION COVER-L,MATT BLACK	1
9	FRONT SUSPENSION LOWER DECORATION COVER-L BASE COLOR	1
10	FRONT LICENCE PLATE BRACKET-FRONT MATT BLACK	1
11	FRONT TURNING LIGHT BRACKET COVER	1
12	FRONT HEADLIGHT BRACKET MATT BALCK	1
13	STEERING STEM ASSY MATT BLACK	1
14	CLAMP FOR SPEED SENSER CABLE,UP MATT BLACK	1
15	CLAMP FOR BRAKE TUBE ,UP MATT BLACK	1
16	STEERING BOLT M14×1.5 CHROME	1
17	STEERING NUT M25×1.0 MILITARY GREEN	1
18	DUSTPROOF COVER	1
19	STEARING KITS	1
20	STEERING STEM WASHER $\phi 31 \times \phi 45 \times 1.5$	1
21	ODOMETER BRACKET MATT BLACK	1
22	FRONT DISC BRAKE OIL TUBE BRACKET MATT BLACK	1

14 - REAR BRAKE PEDAL

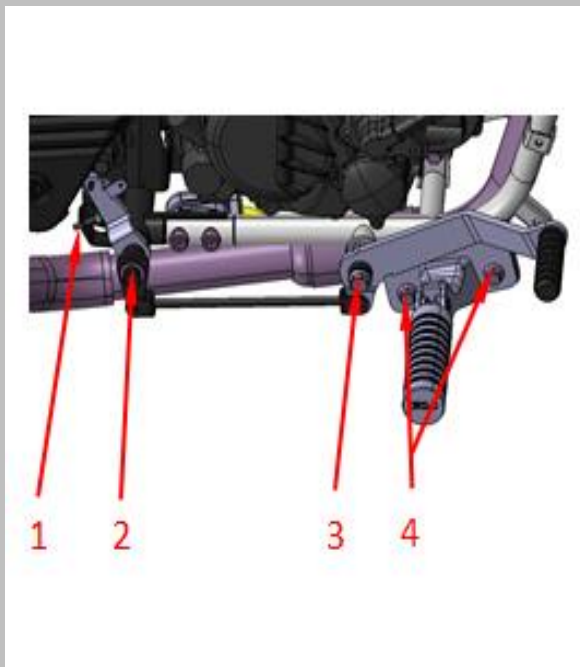

No.	picture	specifications
1		Hexagon Bolt M6-30
		nut M6
2		washer $\Phi 16$
		spring clip $\Phi 14$
3		Hexagon flange bolt M10*1.25-40
4		Hexagon flange bolt M10*1.25-20

BRAKE PLAY/PEDAL POSITION ADJUSTMENT

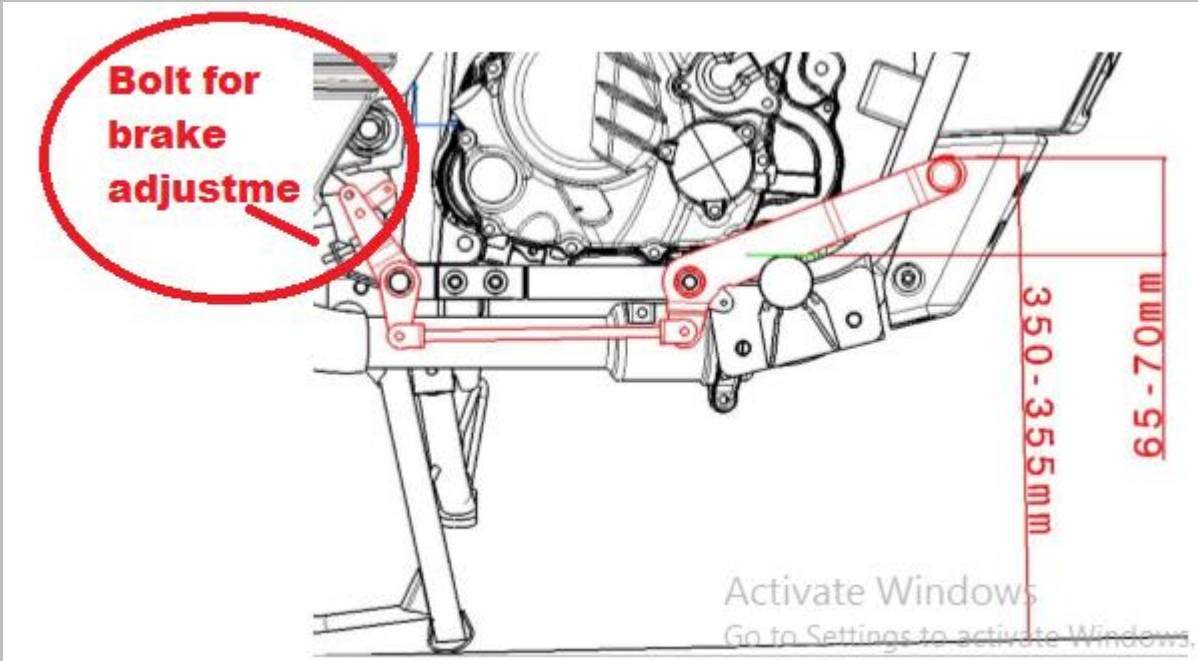

Maintain the Brake Pedal Height as per given specification:

- **Height from Front Footrest Rubber-65-70mm**
- **Height from the ground-350-355mm**

15 -RADIATOR

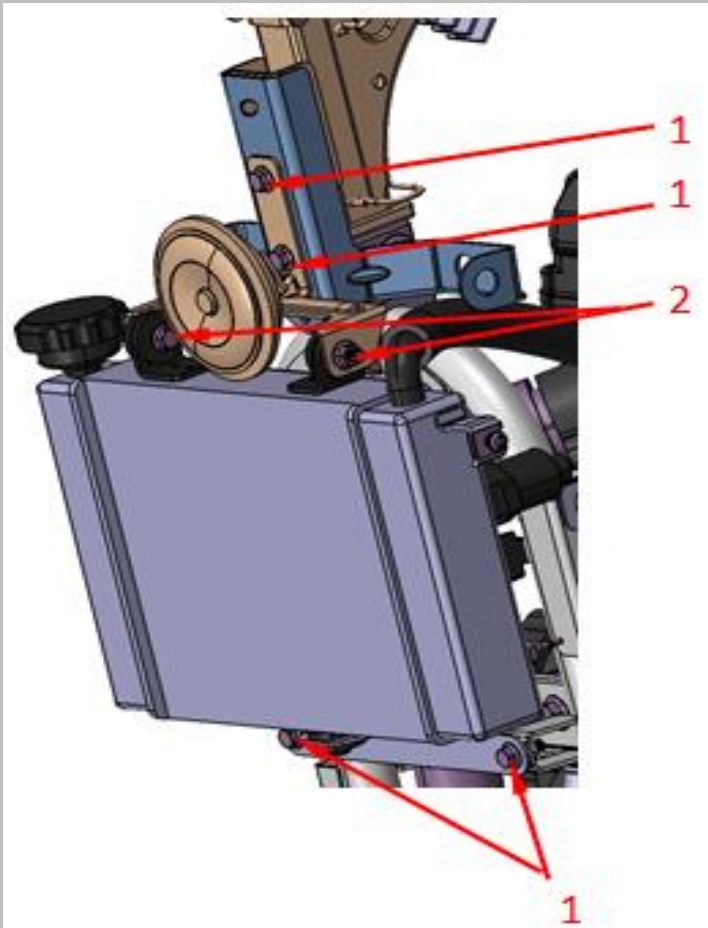

- Drain Complete coolant.
- Loosen all the coolant hoses before dismounting Radiator.

No.	specifications
1	Hexagon flange bolt M6*16
2	Hexagon flange bolt M6*25
	self-lock nut M6

16-SIDE & MAIN STAND



**Check that both the stands are smooth in function.
Check spring for proper fitment & Apply Grease if hard in operation.**

Central stand is tightened with-

1. central stand axle L=130-



2. washer $\Phi 16$



3. spring pin

Side stand is tightened with-

Hexagon flange bolt

M10*1.25-35-



17 - SUB FRAME & ENGINE MOUNTING WITH CHASSIS



Before removing Engine from Chassis ensure that-

- **Clutch cable is disconnected from Clutch cover.**
- **Magneto & Switch gear indication wires are disconnected from wiring harness.**
- **Coolant is totally drained from engine & radiator.**
- **Radiator is removed from chassis.**
- **Muffler silencer is removed from Engine.**
- **Drive chain is disconnected from engine sprocket.**
- **Carburetor is disconnected from Intake manifold.**
- **Disconnect Gear shifting assembly.**

SUB FRAME & ENGINE MOUNTING WITH CHASSIS

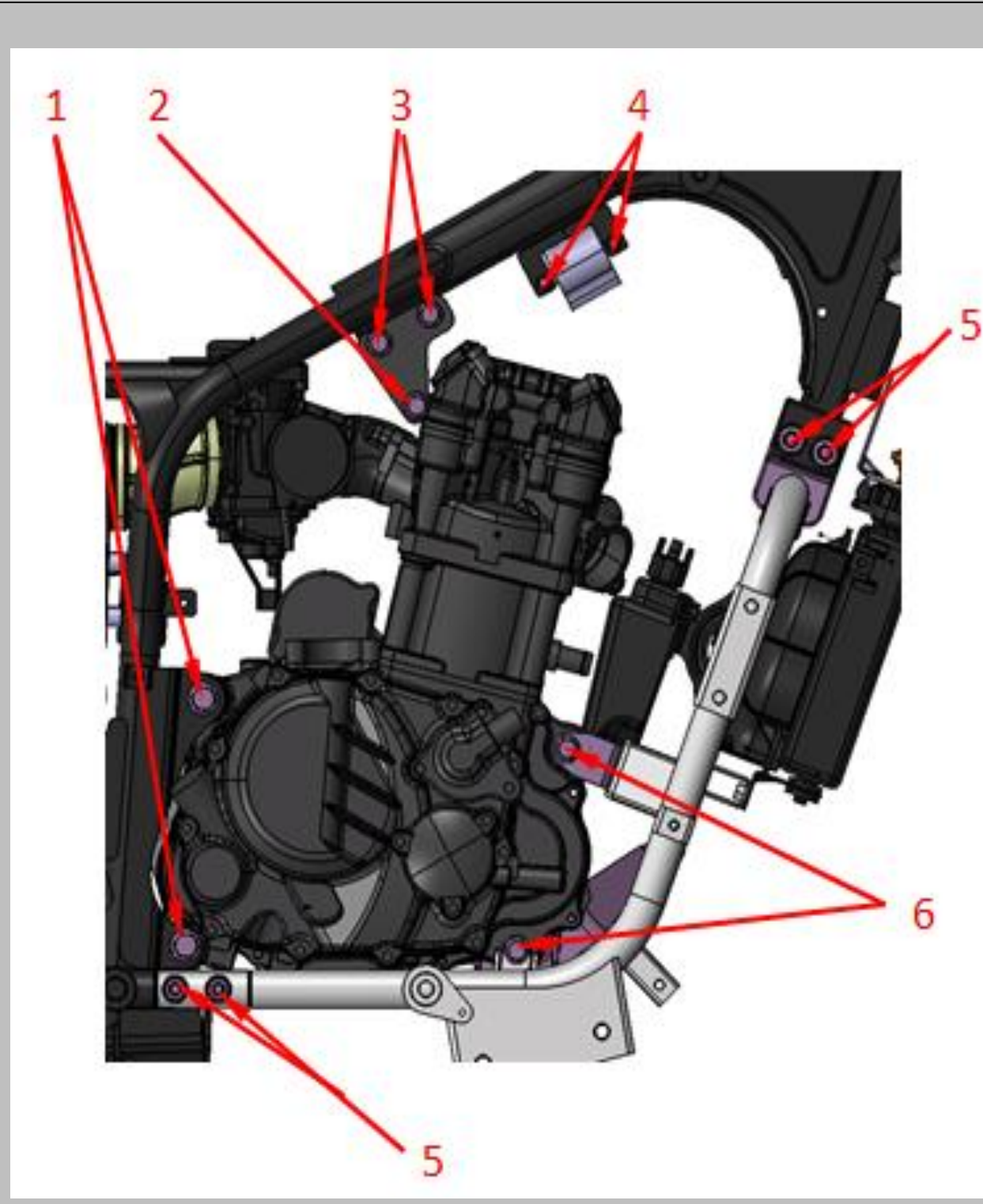

SUB FRAME & ENGINE MOUNTING WITH CHASSIS

No.	specifications	Torque
1	Hexagon flange bolt M10*1.25-110	
	self-lock nut M10*1.25	55~65 Nm
2	Allen Bolt M8-60	
	self-lock nut M8	28~32 Nm
3	Hexagon flange bolt M8-60	
	self-lock nut M8	28~32 Nm
4	M6*20	
5	Allen Bolt M10*1.25-30	
	Hexagon nut M10*1.25	55~65 Nm
6	Hexagon flange bolt M8-90	
	Self-lock nut M8	28~32 Nm

SERVICE MANUAL VER. B170626